



## St. Peters Street, Stamford, PE9 2PF

Rent - £1,500 Per Month      Deposit - £1,730

A beautifully renovated Grade II listed townhouse in the heart of Stamford. This charming mid-terrace property has been thoughtfully refurbished to a high standard throughout, blending period character with stylish modern finishes.

The ground floor features a brand new fitted kitchen, a convenient W/C, and a bright reception room with contemporary décor. On the first floor, there's a second reception room (which could also serve as an additional

- GRADE II LISTED MID-TERRACE TOWNHOUSE
- BEAUTIFULLY RENOVATED TO A HIGH STANDARD THROUGHOUT
- BRAND NEW FITTED KITCHEN
- LOCATED IN THE HEART OF STAMFORD
- RARE TOWN CENTRE GARAGE WITH PARKING SPACE
- THREE/ FOUR BEDROOMS
- TWO MODERN SHOWEROOMS
- EPC RATING - E
- COUNCIL TAX BAND - D
- WALKING DISTANCE TO LOCAL AMENITIES



Council Tax Band: D - EPC Rating: E 53

GROUND FLOOR



1ST FLOOR

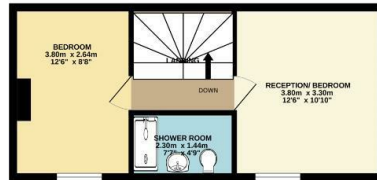

2ND FLOOR



TOTAL FLOOR AREA: 101.0 sq.m. (1087 sq.ft.) approx.  
Whilst every attempt has been made to ensure the accuracy of the floorplan contained here, measurements of doors, windows, rooms and any other items are approximate and no responsibility is taken for any error, omission or mis-statement. This plan is for illustrative purposes only and should be used as such by any prospective purchaser. The services, systems and appliances shown have not been tested and no guarantee as to their operability or efficiency can be given.  
Made with Metropix ©2025

